

Birchley Suite

The Birchley Suite is our principle conference and events space. As one of the largest multifunctional rooms in the midlands we can cater for larger conferences, product launches, exhibitions and banqueting. This versatile space is pre-rigged with a vast array of audio visual and lighting equipment to ensure your event stands out. Combine with our AV package for instant WOW with minimum fuss. The room can be split into 3 sections, adapting the space to suit the numbers and occasion.

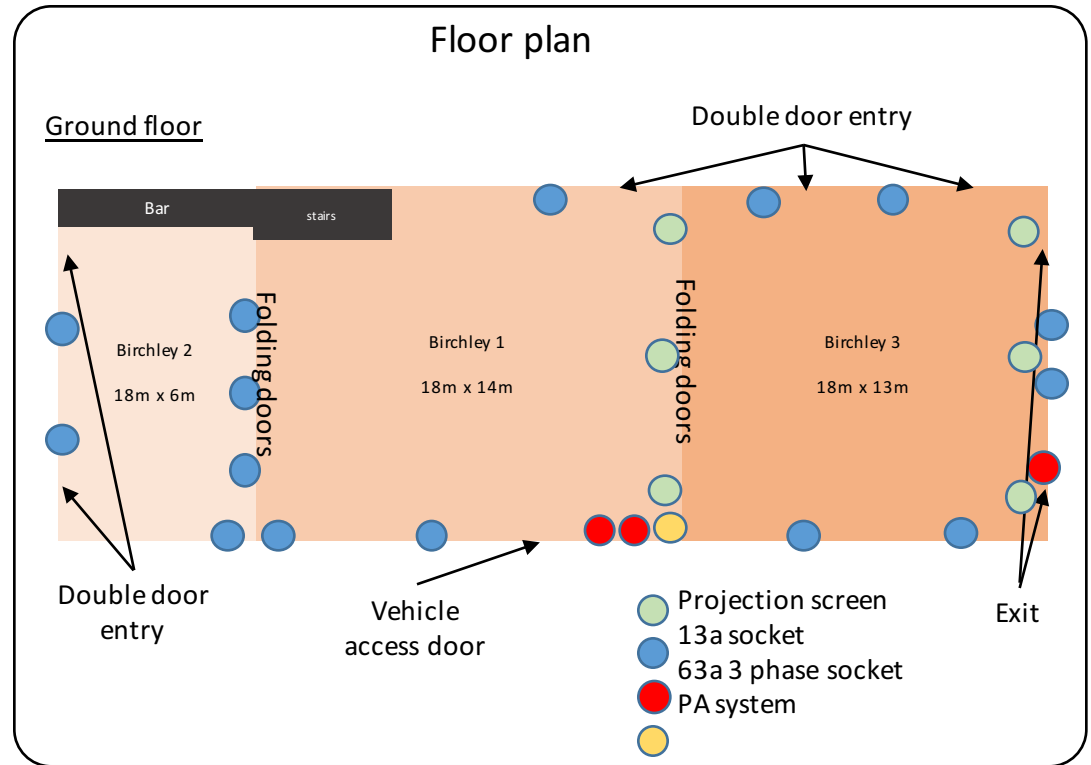

Technical Specification

Dimensions – 33m x 18m
 Ceiling Height – 2.4m / 5m +
 Power – single & 3phase
 Lighting – LED, Discharge & effects
 Air Conditioning – Yes
 AV – PA system & multiple screens
 Blackout – Yes (no natural light)
 Access – ground floor 4.5m x 5m door
 Internet – Wired & wireless
 Other – Full led star-cloth drape
 Other - Own Bar

Capacities

Theatre 650 	Classroom 200
Cabaret 350 	Dinner 500
Boardroom 40 	Reception 600